

Soils Map

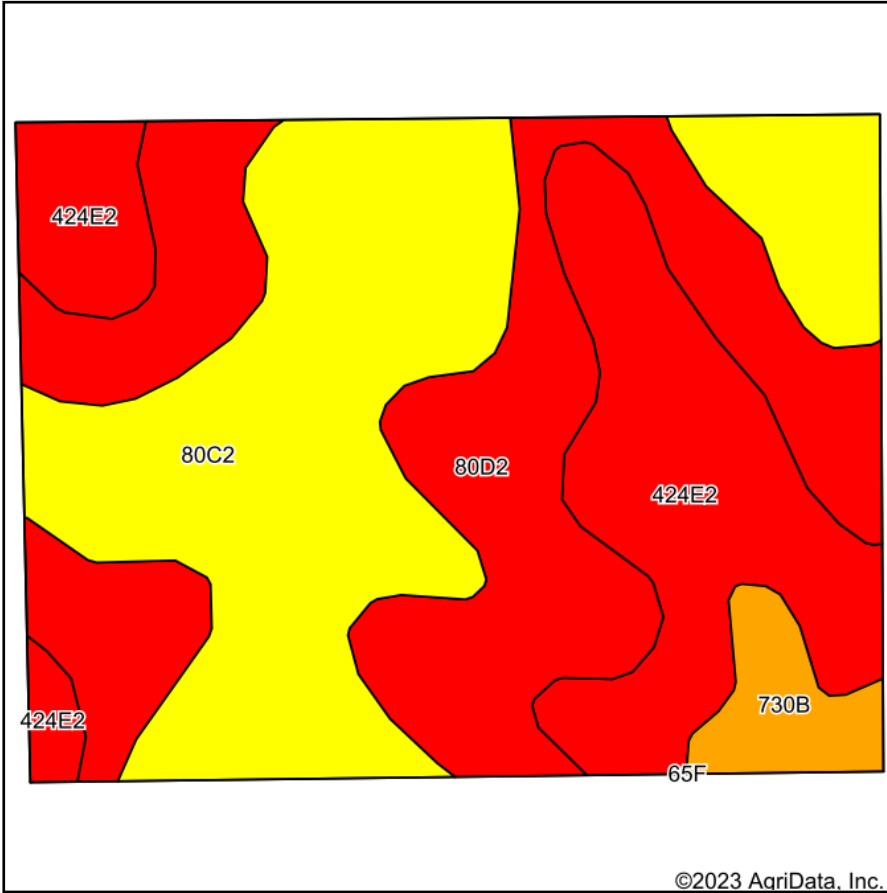

Soils data provided by USDA and NRCS.

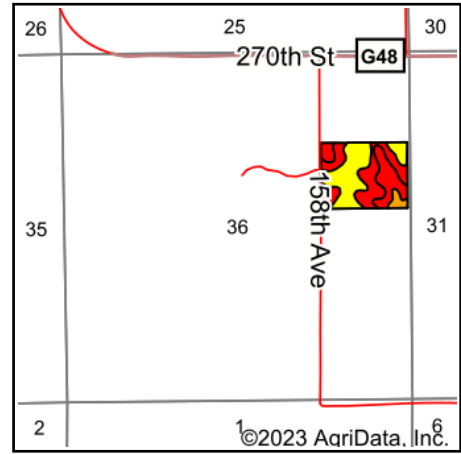

State: **Iowa**
 County: **Keokuk**
 Location: **36-75N-13W**
 Township: **West Lancaster**
 Acres: **30**
 Date: **9/25/2023**



Maps Provided By:



© AgriData, Inc. 2023

www.AgriDataInc.com



Area Symbol: IA107, Soil Area Version: 27

Code	Soil Description	Acres	Percent of field	CSR2 Legend	Non-Irr Class *c	CSR2**	CSR	*n NCCPI Overall	*n NCCPI Corn	*n NCCPI Small Grains	*n NCCPI Soybeans	
80C2	Clinton silty clay loam, 5 to 9 percent slopes, eroded	11.44	38.1%	Yellow	IIIe	69	60	74	74	64	61	
80D2	Clinton silty clay loam, 9 to 14 percent slopes, eroded	10.34	34.5%	Red	IIIe	46	50	72	72	62	58	
424E2	Lindley-Keswick complex, 14 to 18 percent slopes, moderately eroded	7.05	23.5%	Red	VIe	21	5	57	54	43	44	
730B	Nodaway occasionally flooded-Coppock-Cantrel rarely flooded complex, 2 to 5 percent slopes	1.17	3.9%	Orange	IIw	76	61	83	78	54	78	
Weighted Average						3.67	50.1	43.7	*n 69.7	*n 68.8	*n 58	*n 56.6

**IA has updated the CSR values for each county to CSR2.

*n: The aggregation method is "Weighted Average using all components"

*c: Using Capabilities Class Dominant Condition Aggregation Method

Soils data provided by USDA and NRCS.