

Soils Map

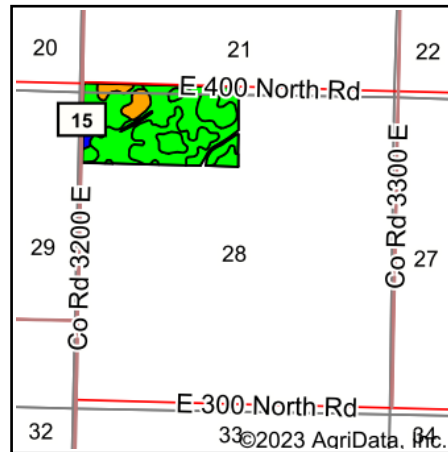
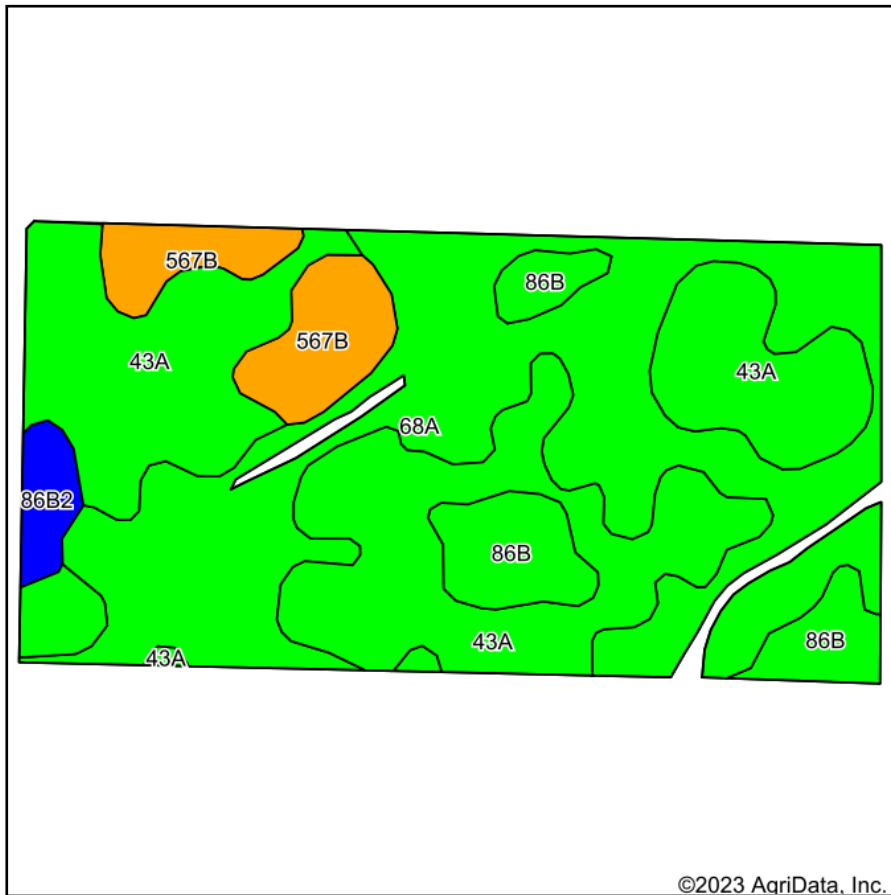

State: **Illinois**
 County: **McLean**
 Location: **28-22N-5E**
 Township: **West**
 Acres: **78.97**
 Date: **3/20/2023**

©2023 AgriData, Inc.

Maps Provided By:



Soils data provided by USDA and NRCS.

Area Symbol: IL113, Soil Area Version: 18													
Code	Soil Description	Acres	Percent of field	Il. State Productivity Index Legend	Subsoil rooting ^a	Corn Bu/A	Soybeans Bu/A	Wheat Bu/A	Oats Bu/A ^b	Sorghum ^c Bu/A	Alfalfa ^d hay, T/A	Grass-legume ^e hay, T/A	Crop productivity index for optimum management
43A	Ipava silt loam, 0 to 2 percent slopes	32.85	41.6%		FAV	191	62	77	100	0	0.00	5.90	142
68A	Sable silty clay loam, 0 to 2 percent slopes	32.23	40.8%		FAV	192	63	74	99	0	0.00	5.77	143
**86B	Osco silt loam, 2 to 5 percent slopes	6.38	8.1%		FAV	**189	**59	**74	**101	0	**6.83	0.00	**140
**567B	Elkhart silt loam, 2 to 5 percent slopes	5.89	7.5%		FAV	**169	**53	**64	**81	0	**5.22	0.00	**124
**86B2	Osco silt loam, 2 to 5 percent slopes, eroded	1.62	2.1%		FAV	**181	**57	**71	**97	0	**6.56	0.00	**134
Weighted Average						189.4	61.4	74.4	98.2	*-	1.08	4.81	140.7

Table: Optimum Crop Productivity Ratings for Illinois Soil by K.R. Olson and J.M. Lang, Office of Research, ACES, University of Illinois at Champaign-Urbana. Version: 1/2/2012 Amended Table S2 B811

Crop yields and productivity indices for optimum management (B811) are maintained at the following NRES web site: <http://soilproductivity.nres.illinois.edu/>

** Indexes adjusted for slope and erosion according to Bulletin 811 Table S3

^a UNF = unfavorable; FAV = favorable

^b Soils in the southern region were not rated for oats and are shown with a zero "0".

^c Soils in the northern region or in both regions were not rated for grain sorghum and are shown with a zero "0".

^d Soils in the poorly drained group were not rated for alfalfa and are shown with a zero "0".

^e Soils in the well drained group were not rated for grass-legume and are shown with a zero "0".

Soils data provided by USDA and NRCS. Soils data provided by University of Illinois at Champaign-Urbana.