

Soils Map

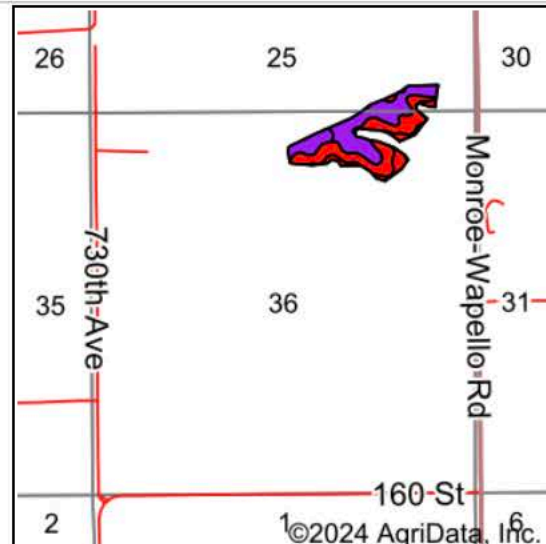

State: **Iowa**
 County: **Monroe**
 Location: **36-73N-16W**
 Township: **Pleasant**
 Acres: **27.92**
 Date: **11/15/2024**

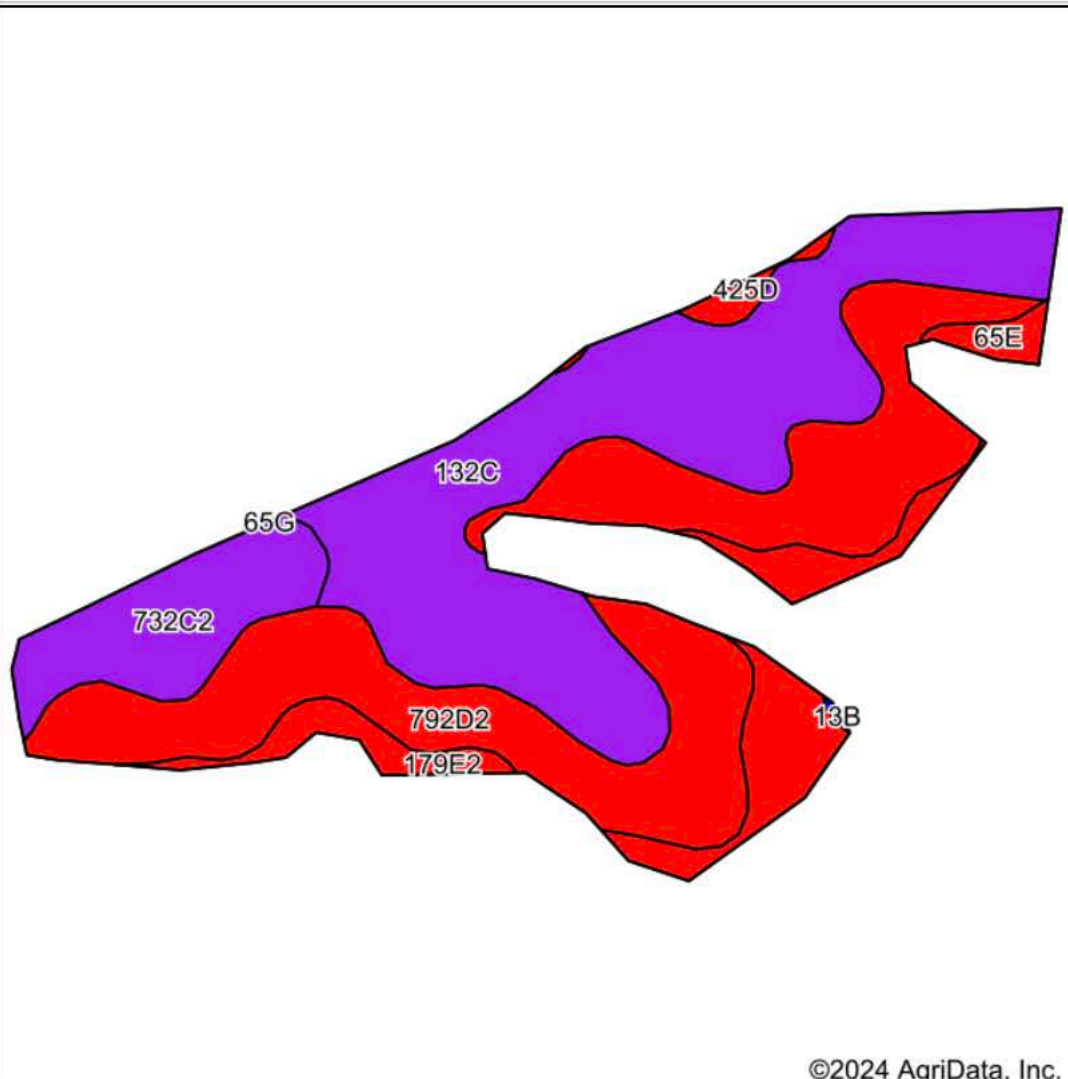

Soils data provided by USDA and NRCS.

©2024 AgriData, Inc.

© AgriData, Inc. 2023

www.AgriDataInc.com

Area Symbol: IA135, Soil Area Version: 32

Code	Soil Description	Acres	Percent of field	CSR2 Legend	Non-Irr Class *c	CSR2**	CSR	*n NCCPI Overall	*n NCCPI Corn	*n NCCPI Small Grains	*n NCCPI Soybeans	
132C	Weller silt loam, 5 to 9 percent slopes	10.96	39.3%		IIIe	59	44	85	85	74	73	
792D2	Armstrong loam, 9 to 14 percent slopes, moderately eroded	10.67	38.2%		IVe	9	13	62	62	54	43	
179E2	Gara loam, 14 to 18 percent slopes, moderately eroded	2.84	10.2%		VIe	35	33	68	68	53	51	
732C2	Weller silty clay loam, 5 to 9 percent slopes, moderately eroded	2.80	10.0%		IIIe	59	40	81	81	69	67	
65E	Lindley loam, 14 to 18 percent slopes	0.36	1.3%		VIe	33	30	71	71	61	60	
425D	Keswick loam, 9 to 14 percent slopes	0.29	1.0%		IVe	8	16	62	62	58	48	
Weighted Average						3.74	36.6	30.2	*n 73.7	*n 73.7	*n 63.4	*n 58.3

**IA has updated the CSR values for each county to CSR2.

*n: The aggregation method is "Weighted Average using all components"

*c: Using Capabilities Class Dominant Condition Aggregation Method