

# Soils Map

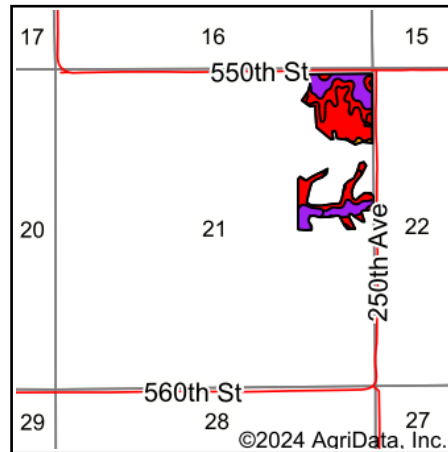

State: **Iowa**  
 County: **Appanoose**  
 Location: **21-68N-17W**  
 Township: **Caldwell**  
 Acres: **37.13**  
 Date: **12/11/2024**

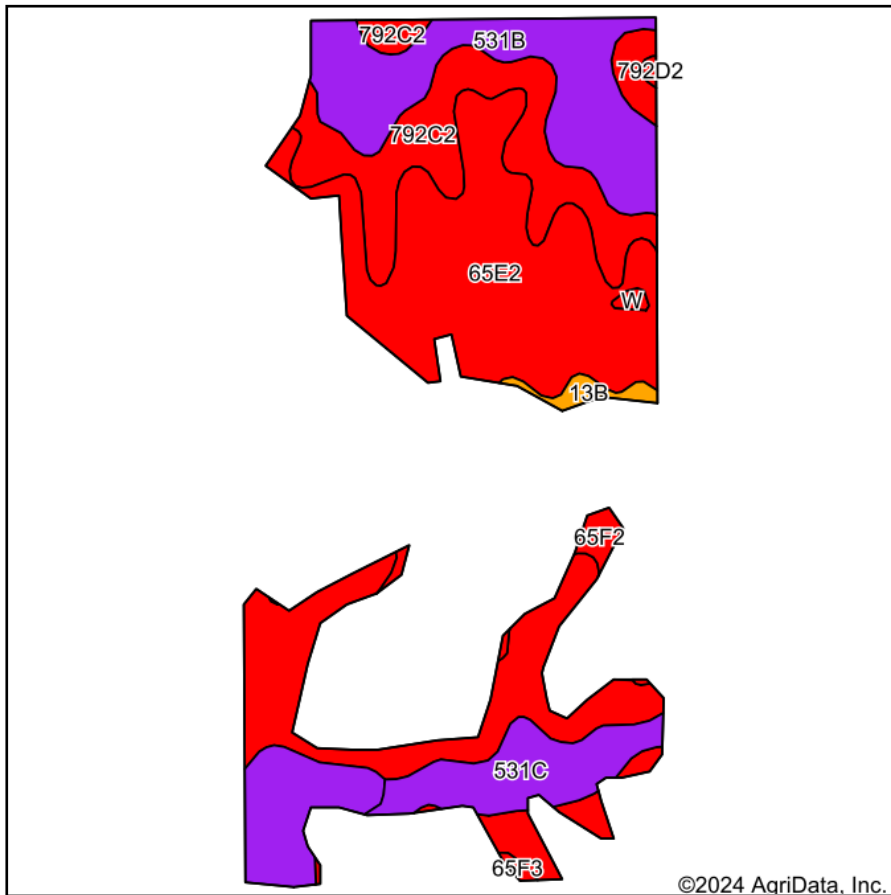

Soils data provided by USDA and NRCS.

©2024 AgriData, Inc.

Area Symbol: IA007, Soil Area Version: 31

Code	Soil Description	Acres	Percent of field	CSR2 Legend	Non-Irr Class *c	CSR2**	CSR	*n NCCPI Overall	*n NCCPI Corn	*n NCCPI Small Grains	*n NCCPI Soybeans	
792C2	Armstrong loam, 5 to 9 percent slopes, moderately eroded	13.26	35.7%		IIIe	31	26	65	65	58	47	
65E2	Lindley loam, 14 to 18 percent slopes, moderately eroded	11.12	29.9%		Vle	29	28	66	66	56	53	
531B	Kniffin silt loam, 2 to 5 percent slopes	8.57	23.1%		IIIe	55	58	69	64	69	66	
531C	Kniffin silt loam, 5 to 9 percent slopes	3.00	8.1%		IIIe	52	36	67	62	67	64	
65F2	Lindley loam, 18 to 25 percent slopes, moderately eroded	0.47	1.3%		VIIe	10	10	51	51	35	37	
13B	Olmitz-Vesser-Colo complex, 2 to 5 percent slopes	0.43	1.2%		IIw	79	68	86	81	54	80	
W	Water	0.12	0.3%			0	0					
65F3	Lindley soils, 18 to 24 percent slopes, severely eroded	0.09	0.2%		VIIe	7	10	56	56	36	35	
792D2	Armstrong loam, 9 to 14 percent slopes, moderately eroded	0.07	0.2%		IVe	9	11	62	62	54	43	
<b>Weighted Average</b>						<b>*-</b>	<b>37.7</b>	<b>34.9</b>	<b>*n 66.2</b>	<b>*n 64.6</b>	<b>*n 60.1</b>	<b>*n 54.6</b>

\*\*IA has updated the CSR values for each county to CSR2.

\*n: The aggregation method is "Weighted Average using all components"

\*c: Using Capabilities Class Dominant Condition Aggregation Method

\*- Non Irr Class weighted average cannot be calculated on the current soils data due to missing data.